



Installation Manual

Entertainer Speaker

Model: | E60



Table of Contents

Introduction.....	1
Installation Requirements and Recommendations.....	1
What's included.....	1
Required Tools/Items.....	1
Optional Tools/Items.....	2
Speaker Placement.....	3
Home Theater (5 Speakers).....	3
Installation.....	4
1) Installing the Wire.....	4
2) Painting the Grille.....	5
3) Cutting the Hole (Retrofit Installation)	6
4) Connecting the Wires.....	6
5) Installing the Speaker	7
6) Aiming the Tweeter.....	7
7) Installing the Grille.....	7
Troubleshooting.....	8
Technical Assistance.....	9
Specifications.....	10
Warranty.....	11
Limited Lifetime Warranty.....	11
Requirements and Warranty Coverage.....	12
Return Process.....	12

Introduction

Thank you for purchasing the E60 In-Ceiling Entertainer Speaker. At Origin Acoustics, we take pride in providing you with a high quality product. All of Origin Acoustics' speakers are designed to have excellent sound quality, longevity, and a simple installation process.

This instruction booklet covers the necessary information for a smooth installation of your Entertainer Speaker, including the tools you will need, step-by-step instructions, troubleshooting tips for any errors that may occur and all warranty information. If for any reason you experience problems or if you have installation questions please call us at (844) 674-4461. Hours of operation are 8:00am to 5:00pm (Pacific Time), Monday through Friday.

Installation Requirements and Recommendations

What's included

- Template
- Speaker
- Grille

Required Tools/Items

- Keyhole or drywall saw
- Speaker wire
- Pencil
- Wire stripper
- Measuring tape
- Screwdriver or drill



Speaker Wire Recommendations

For this setup, use a multi-stranded wiring designed for amplifier to speaker connections. The gauge of wire used can have an impact on the performance of your speakers and we would recommend that you choose the largest wire size that is practical for your installation. Which gauge to select depends on the length of wire to be used on any particular speaker. In general

the shorter the run the smaller the wire size you can use, however you can never go wrong by using a thicker gauge.

Wire Length		Recommend- ed Gauge
Feet	Meter	
0-100	0-30	16
50-150	15-45	14
100+	30+	12

Optional Tools/Items

- Drill with 1/8" (3mm) drill bit To check for obstacles in ceiling
- Stiff wire (like from a coat hanger) To check for obstacles in ceiling
- Stud finder To check for obstacles in ceiling
- Fish tape To route wire through walls
- Can of spray paint For painting the grille
- Can of compressed air For painting the grille

Speaker Placement

Auxiliary Room (2 Speakers)

Ideally the two speakers would be placed an equal distance from the listener and no less than 6' (2m) apart. If the room has a lower ceiling or if the speakers are intended for standing (as opposed to sitting) listeners, the speakers may be closer together. The first image shows the sound coverage in the room.

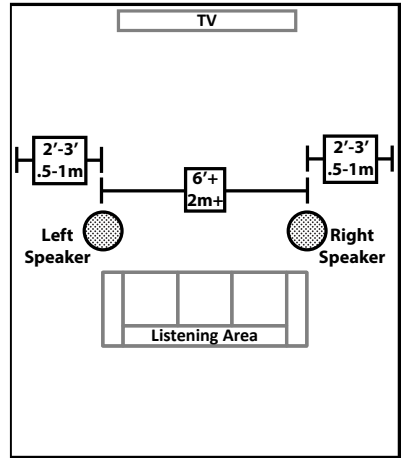
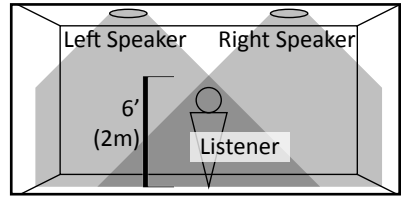

Home Theater (5 Speakers)

The Left Rear (LR) and Right Rear (RR) speakers should be installed just behind the listener, one on either side. The Center Channel (CC) speaker should be placed above and slightly in front of the television, with the Left Front (LF) and Right Front (RF) speakers placed equidistant to either side.

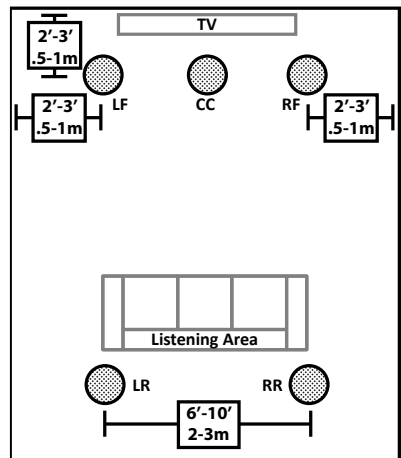



Installation

1) Installing the Wire

Strip $\frac{1}{4}$ to $\frac{1}{2}$ inches (6 to 12 mm) of the insulation off both ends of the wire. To avoid stray strands, twist them at the end.

Connect the wire to the amplifier, and make sure the wire connected to the left speaker output will be routed to the left speaker, right output to right speaker, etc.

Plan how you'll route the wire to the desired speaker location. There are several methods for routing the wire, and you may need to combine several of them.

Under the Carpet:

One option is to lift up the carpet and rout "tape wire" under the carpet.

Behind the Baseboard:

The wire can be routed behind the baseboard by cutting a groove out of the back of the baseboard, or by buying special baseboard designed for concealing wires.

Through an Attic, Crawlspace or Basement:

When available, you can route the wire through an attic or crawlspace.

Through walls:

When running wires through a wall, be sure to avoid all obstacles such as AC wiring, pipes, and ducts.

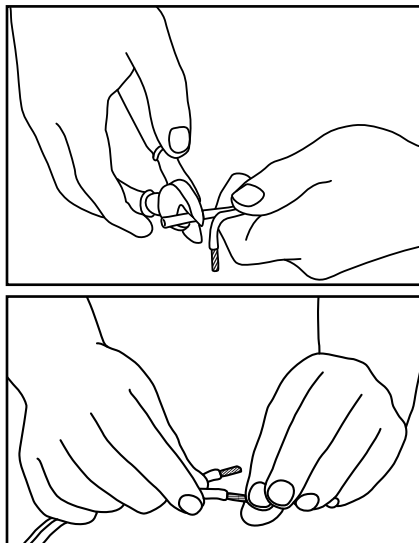

About Speaker Wire

You will need a wire that has at least two conductors; one that can be identified as the positive and the other as the negative. All two conductor wires have some means of identifying which conductor is which, but at times this identification may be subtle. It's crucial that you keep track of which wire you use for positive (+) and negative (-). Typically if the wires are colored red and black, the red wire is used for positive and the black wire is used for negative, but sometimes other colors or patterns are used. You can choose whichever color of wire you want to be positive and negative as long as you remain consistent throughout the install.

On both your amplifier and your speaker the connectors will be identified as red for positive and black for negative. It is very important to look carefully at the speaker wires and be certain that the same wire that is attached to the positive connector in the amplifier is attached to the positive connector in the speaker.

2) Painting the Grille

In some situations the speakers may look better if the color matched the walls, ceiling, or trim in the room. This can be accomplished by painting the grille. The grille must be painted with spray paint, and most hardware stores will mix a can of paint to match whatever color you need.

Before painting, carefully remove the thin cloth on the underside of the grille. Lightly spray the front of the grille with the paint from a distance, being careful not to plug any of the holes. Diluting the paint with paint thinner will lessen the risk of filling any holes. If a hole gets plugged use a can of compressed air to open it. Once the paint is dry, put the cloth back on the grille.

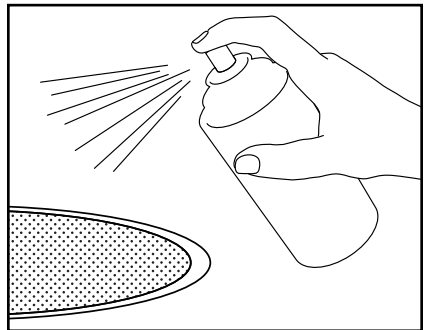
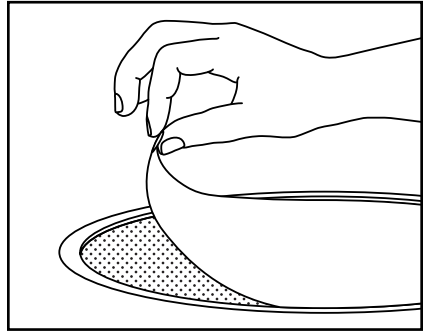



3) Cutting the Hole (Retrofit Installation)

Cutout Hole size: 210mm (8¼")

When you've decided on the locations for all of the speakers, use the template to trace a circle lightly in pencil where the hole should be. (If you don't have a template, check the Specifications section for cutout sizes.) If you're unsure on whether there may be obstacles (such as pipes or wires) where you plan on installing the speaker, drill a ⅛ inch hole in the center of the circle, then put a bent coat hanger through the hole to feel around. Use a keyhole or drywall saw to cut the hole.

For New Construction

If these speakers are being installed during home construction, the installation process will be a bit different (although much simpler). For these situations it's recommended you purchase an Origin Acoustics BR68 bracket (for the Director 6/8 collection), though the BRP6 (for the Producer 6 collection) will also work. Bracket installation instructions are provided with the bracket, or can be found on our website (www.originacoustics.com).

4) Connecting the Wires

Insert the wires into the connectors, making sure that the positive wire is being attached to the red connection and the negative wire is being attached to the black connection. If the negative and positive wires are switched, speaker performance will be drastically impacted.

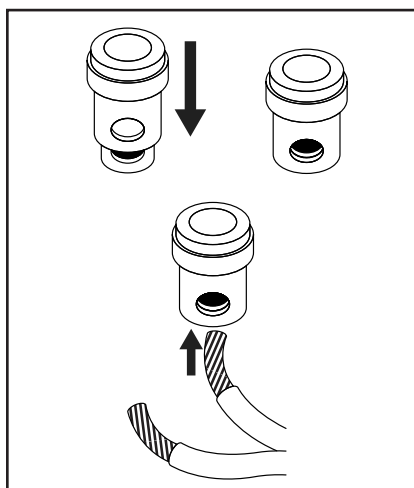

5) Installing the Speaker

The E60 has the ability to fit two different sized new construction brackets from Origin Acoustics. If the ceiling already has BR68 brackets then the E60 can be installed using the standard dog mounting system (see following paragraph). If there are already BRP6 brackets installed in ceiling, simply turn out the 4 smaller “Spacer Tabs” on the E60. This will allow for the E60 to be centered for the BRP6 bracket.

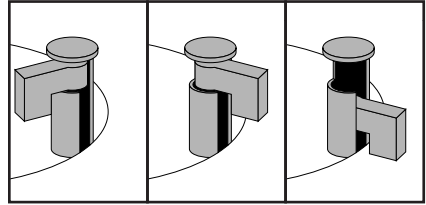
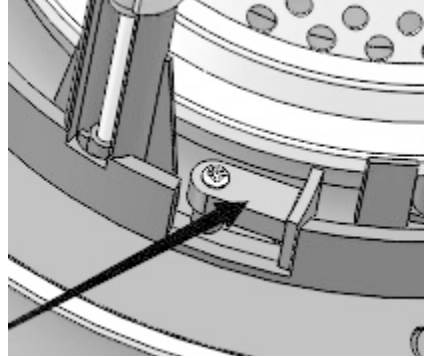

Make sure all the dogs are in the upright position and facing to the side, not outwards. Insert the speaker into the hole. Turn the four screws so that the dogs face outwards and continue turning until they clamp down on the ceiling. When you feel resistance, stop tightening the screws. Do not over tighten.

6) Aiming the Tweeter

The tweeter may provide some resistance, so firmly grip the outside of the tweeter to aim it towards the listening area.

7) Installing the Grille

Fit the grille over the speaker. The grille uses magnets to be held in place.



Troubleshooting

If possible, it's often good to try to isolate the problem first. For example, if you're playing a DVD on a television and there's no sound, try connecting an MP3 player to the system to see if that works. If it does work, then the problem is with the television, DVD player, or the cables connecting them. If it doesn't work, the problem will be with the amplifier, speakers, or those cables.

Problem	Possible Cause
No Sound	The volume may be turned down or muted. Check the volume settings on both the amplifier and the television/computer/CD player/etc.
	Make sure the proper source is selected on the amplifier or receiver.
	Check the cord connecting the amplifier with the source. The cord may be damaged or plugged into the wrong input or output.
	Check the wires connecting the amplifier with the speakers. Make sure they're connected properly and not damaged in any way.
Poor Sound Quality	If you hear something like static, or the sound is cutting in and out, check the audio cables. If the problem increases when a cable is being moved, then the cable is most likely faulty or not connected properly.
	Today's audio systems may have several places to adjust the volume, for example your MP3 player may have a volume control, and your amplifier may also have one. Check to be certain that the volume isn't turned up past 80% on any device.
	Try changing sources to be certain that the selection you've chosen is a good quality recording.

Technical Assistance

If you have any questions or concerns about installing or using this product, you can reach us through one of the following methods:

Phone: (844) 674-4461

Hours of operation: 8:00am - 5:00pm (Pacific Time), Mon - Fri

Email: techsupport@originacoustics.com

If you are having technical trouble, please include the model number and briefly explain what steps you took to resolve the problem in your email, or be prepared to answer these questions over the phone. If you are considering returning the product, it's required that you contact Origin Acoustics prior to any return attempts. This way we can determine if the issue can be resolved without returning the product, or if needed we can provide instructions and support for the return process.



Specifications

Model Number	E60
Part Number	SCE60000
Tweeter Dome	Silk
Tweeter Diameter	0.5" (13mm)
Woofer Cone	Polypropylene
Woofer Diameter	6.5" (165mm)
Frequency Response	48Hz-20kHz
Impedance	8 ohm
Power Handling	5-100 watts
Sensitivity	86dB \pm 3dB
Diameter	9.61" (244mm)
Grille Diameter	10" (255mm)
Cutout Diameter	8" (202mm) or 8.75" (222mm)
Mounting Depth	3.52" (89mm)

Warranty

Limited Lifetime Warranty

Origin Acoustics warrants to the original retail purchaser only that this Origin Acoustics product will be free from defects in materials and workmanship, provided the speaker was purchased from an Origin Acoustics authorized dealer.

If the product is determined to be defective, it will be repaired or replaced at Origin Acoustics' discretion. If the product must be replaced yet it is no longer manufactured, it will be replaced with a model of equal to or greater value that is the most similar to the original. If this is the case, installing the replacement model may require mounting modifications; Origin Acoustics will not be responsible for any such related costs.



Requirements and Warranty Coverage

This warranty may not be valid if the product was purchased through an unauthorized dealer. This warranty only applies to the individual that made the original purchase, and it cannot be applied to other purchases. The purchaser must be prepared to provide proof of purchase (receipt). This warranty will not be valid if the identifying number or serial number has been removed, defaced, or altered.

This warranty does not cover the following:

- Accidental damage
- Damage caused by abuse or misuse
- Damage caused by attempted repairs/modifications by anyone other than Origin Acoustics or an authorized dealer
- Damage caused by improper installation
- Normal wear, maintenance, and environmental issues
- Damage caused by voltage inputs in excess of the rated maximum of the unit
- Damage inflicted during the return shipment

Return Process

Before making any return attempts, it is required that you first contact Origin Acoustics. Return product to Origin Acoustics or your dealer, either in person or by mail. It's preferable if the product is returned in the original packaging. If this isn't possible, the customer is responsible for insuring the shipment for the full value of the product.

This warranty is in lieu of all other expressed or implied warranties. Some states do not allow limitations on implied warranties, so this may not apply depending on the customer's location. (For more information, see Magnuson-Moss Warranty Act.)

©2014 Origin Acoustics. All copyrighted, trademarked and patented elements mentioned herein are the sole property of Origin Acoustics.

